

4PCE15E

15 SEER Electric / Electric
Packaged Unit

Product Specifications

Form No. 4PCE15E-100 (05/2013)

REFRIGERANT SYSTEM

- Heavy-duty, high efficiency scroll compressor
- Copper tubing with enhanced fin coils
- R410a refrigerant environmentally friendly

CABINET

- Insulated to minimize heat loss
- Baked polyester paint finish over galvanized steel for maximum durability
- Easy service access
- Louvered grille to protect condenser coil
- One piece "no leak" top design
- Weather protected heavy-duty condenser fan motor



BLOWER

- Insulated compartment to reduce sound
- Easy service split-ring design with quick plug-in wiring
- ECM variable speed motor for low maintenance and maximum efficiency
- Dynamically balanced blower wheel with resilient motor mounts for smooth and quiet operation

CONTROLS

- Integrated control with LED diagnostics
- Trade available components
- High pressure switch for system protection
- Color coded wiring for easy service

INSTALLATION

- Horizontal or down discharge

ACCESSORIES

- Hinged Roofcurb 8" and 14"
- Lifting Brackets
- Filter Rack Kit
- Electric Strip Heat Kits (5 - 20 kW)
- Single Point Power Entry Kit

WARRANTY

- 10 year limited warranty on compressor
- 5 year limited warranty on all parts
- Extended warranties available



Model Number Guide

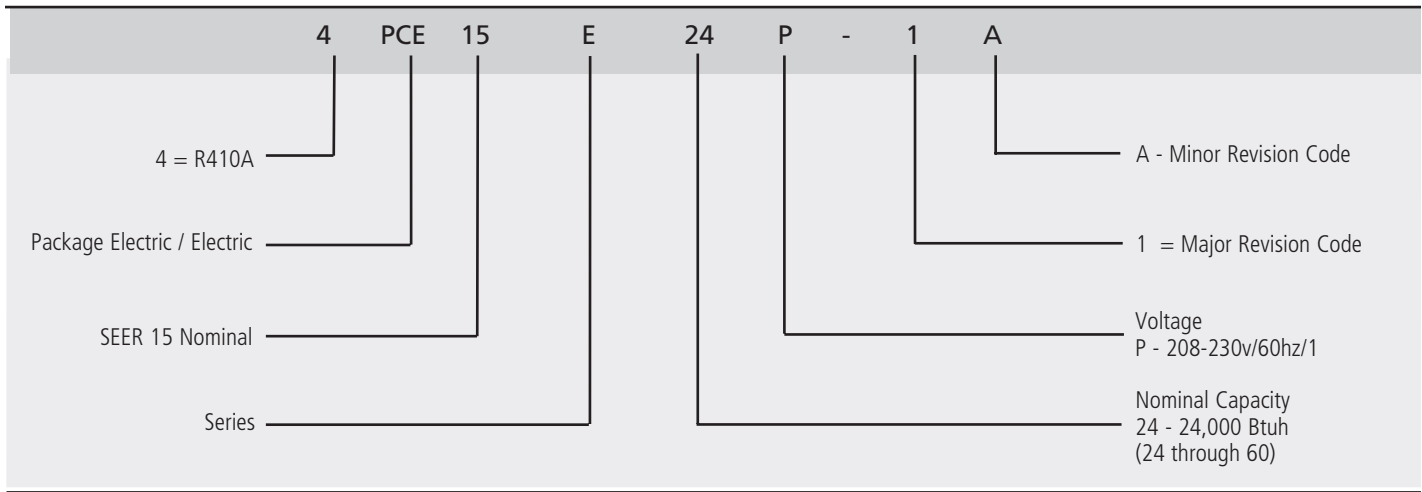

Electrical and Physical Data

Model	Voltage/HZ/ Phase	Voltage Range	Min. Circuit Amp.	Max. Over Current Device (amps)	Compressor		Condenser Fan Motor			Indoor Blower Motor		Refrig. Charge	Shipping Weight (lbs.)
					Rated Load (amps)	Locked Rotor (amps)	Rated Load (amps)	Rated HP	Nom. RPM	Rated Load (amps)	Rated HP		
4PCE15E24P	208-230/60/1	197-253	23	30	13.4	58	1.1	1/5	1075	2.9	1/3	123	370
4PCE15E30P	208-230/60/1	197-253	24	35	14.1	73	1.1	1/5	1075	2.9	1/3	106	370
4PCE15E36P	208-230/60/1	197-253	24	35	14.1	77	1.1	1/5	1075	3.7	1/2	140	390
4PCE15E42P	208-230/60/1	197-253	32	45	17.9	112	1.7	1/4	825	6.1	3/4	181	500
4PCE15E48P	208-230/60/1	197-253	37	50	21.8	117	1.7	1/4	825	6.1	3/4	189	510
4PCE15E60P	208-230/60/1	197-253	43	60	26.4	134	1.7	1/4	825	6.1	3/4	188	510

NOTE: Weights are product weights without packaging material.

Performance

Model	Cooling				
	SEER	EER	Rated AHRI Capacity ¹ BTUH	Rated Sensible Capacity BTUH	CFM
4PCE15E24P	14.5	12.0	22,800	17,700	800
4PCE15E30P	14.0	12.0	28,200	21,200	1000
4PCE15E36P	15.0	12.0	34,200	26,600	1200
4PCE15E42P	14.5	12.0	41,000	29,900	1400
4PCE15E48P	14.0	11.5	47,000	35,200	1600
4PCE15E60P	14.0	11.5	57,000	41,500	1800

Blower Performance

Model	"ADJUST"	0 through 0.80 in. w.g. (0 through 200 Pa) External Static Pressure Range											
		"COOL"				"HEAT"				"CONTINUOUS FAN" Speed			
		A	B	C	D	A	B	C	D	A	B	C	D
		cfm	cfm	cfm	cfm	cfm	cfm	cfm	cfm	cfm	cfm	cfm	cfm
4PCE15E24P 4PCE15E30P	+	1150	920	690	1035	1150	1150	1150	1150	575	460	345	520
	NORM	1000	800	600	900	1000	1000	1000	1000	500	400	300	450
	-	850	680	510	765	1000	1000	1000	1000	425	340	300	385
4PCE15E36P	+	1380	1150	920	1265	1380	1380	1150	1150	690	575	460	635
	NORM	1200	1000	800	1100	1200	1200	1000	1000	600	500	400	550
	-	1020	850	680	935	1200	1200	1000	1000	510	425	350	470
4PCE15E42P 4PCE15E48P 4PCE15E60P	+	2070	1840	1610	1380	1610	1610	1610	1610	1035	920	805	690
	NORM	1800	1600	1400	1200	1400	1400	1400	1400	900	800	700	600
	-	1530	1360	1190	1020	1400	1400	1400	1400	765	680	595	510

Cooling Performance Extended Ratings

Outdoor Model	Indoor Temp DB/WB °F	Outdoor Temp - DB°F														
		65			82			95			105			115		
		Btuh	S/T	kW	Btuh	S/T	kW	Btuh	S/T	kW	Btuh	S/T	kW	Btuh	S/T	kW
4PCE15E24P	85/72	27,100	.66	1.59	25,100	.68	1.68	24,400	.75	1.86	23,000	.78	2.06	21,500	.80	2.29
	80/67	25,300	.73	1.44	24,200	.73	1.64	23,000	.78	1.85	21,700	.81	2.05	20,300	.83	2.27
	75/63	24,200	.73	1.42	23,000	.73	1.61	21,900	.81	1.84	20,600	.84	2.03	19,300	.87	2.25
	75/57	21,100	1.00	1.40	20,500	1.00	1.60	19,500	1.00	1.80	18,300	1.00	2.00	17,200	1.00	2.20
4PCE15E30P	85/72	33,000	.64	2.00	30,800	.66	2.11	29,900	.73	2.34	28,200	.76	2.60	26,400	.78	2.90
	80/67	31,000	.71	1.80	29,700	.71	2.06	28,200	.76	2.32	26,600	.79	2.58	24,900	.81	2.88
	75/63	29,000	.71	1.78	28,200	.71	2.02	26,800	.79	2.30	25,300	.82	2.56	23,600	.84	2.85
	75/57	25,800	1.00	1.70	25,100	1.00	2.00	23,900	1.00	---	22,500	1.00	2.50	21,000	1.00	2.80
4PCE15E36P	85/72	41,300	.66	2.43	38,200	.68	2.57	37,100	.78	2.83	35,000	.77	3.15	32,700	.80	3.52
	80/67	38,500	.73	2.20	36,800	.73	2.50	35,000	.81	2.82	33,000	.80	3.14	30,900	.83	3.50
	75/63	36,800	.73	2.17	35,000	.73	2.45	33,300	.70	2.80	31,400	.83	3.11	29,300	.86	3.47
	75/57	32,000	1.00	2.10	31,200	1.00	2.40	29,600	1.00	2.70	27,900	1.00	3.00	26,100	1.00	3.40
4PCE15E42P	85/72	49,000	.62	2.89	45,300	.64	3.05	44,000	.73	3.37	41,500	.72	3.75	38,800	.75	4.17
	80/67	45,700	.68	2.61	43,700	.68	2.97	41,500	.76	3.35	39,200	.75	3.73	36,600	.78	4.15
	75/63	43,600	.69	2.58	41,500	.69	2.91	39,400	.72	3.32	37,200	.78	3.69	34,800	.81	4.12
	75/57	37,900	1.00	2.50	36,900	1.00	2.90	35,100	1.00	3.30	33,100	1.00	3.60	31,000	1.00	4.00
4PCE15E48P	85/72	56,100	.63	3.47	51,900	.65	3.67	50,400	.75	4.06	48,000	.74	4.52	45,200	.76	5.05
	80/67	52,300	.70	3.14	50,000	.70	3.57	47,500	.77	4.03	45,200	.77	4.49	42,700	.79	5.00
	75/63	49,900	.71	3.10	47,600	.71	3.51	45,100	.70	4.00	43,000	.79	4.45	40,500	.82	4.96
	75/57	43,400	1.00	3.00	42,400	1.00	3.40	40,100	1.00	3.90	38,300	1.00	4.40	36,000	1.00	4.90
4PCE15E60P	85/72	69,600	.62	4.34	64,400	.64	4.58	62,500	.70	5.08	59,600	.72	5.64	56,200	.74	6.28
	80/67	64,900	.68	3.93	62,100	.68	4.47	59,000	.73	5.04	56,200	.75	5.60	53,000	.77	6.23
	75/63	62,000	.69	3.88	59,100	.69	4.38	56,100	.75	5.00	53,400	.77	5.55	50,400	.79	6.17
	75/57	53,900	1.00	3.80	52,600	1.00	4.30	49,900	1.00	4.90	47,500	1.00	5.40	44,900	1.00	6.00

Heat Strip Electrical (24, 30, 36, 42)

Model No.	Heater Model	Unit Supply Single Phase	Heater kW	Minimum Circuit Ampacity 1	Maximum Fuse / HACR Brkr. 2 1	Minimum Circuit Ampacity 2	Maximum Fuse / HACR Brkr. 2 2	Minimum Circuit Ampacity Single	Max. Fuse/ HACR Brke. Single
4PCE15E24P	PHK05BP	240	5.0	29.7	30	----	---	49.8	50
		208	3.8	26.2	30	----	---	46.4	50
	PHK07BP	240	7.5	42.7	45	----	---	62.9	70
		208	5.6	37.5	40	----	---	57.7	60
	PHK10BP	240	10.0	55.7	60	----	---	75.9	80
		208	7.5	48.8	50	----	---	68.9	70
4PCE13A30P	PHK05BP	240	5.0	29.7	30	----	---	50.6	60
		208	3.8	26.2	30	----	---	47.2	50
	PHK07BP	240	7.5	42.7	45	----	---	63.7	70
		208	5.6	37.5	40	----	---	58.5	60
	PHK10BP	240	10.0	55.7	60	----	---	76.7	80
		208	7.5	48.8	50	----	---	69.7	70
4PCE13A36P	PHK05BP	240	5.0	30.7	35	----	---	51.4	60
		208	3.8	27.2	30	----	---	48	50
	PHK07BP	240	7.5	43.7	45	----	---	64.5	70
		208	5.6	38.5	40	----	---	59.3	60
	PHK10BP	240	10.0	56.7	60	----	---	77.5	80
		208	7.5	49.8	50	----	---	70.5	80
PHK15CP	240	15.0	56.7	60	26	30	103.5	110	
	208	11.3	49.8	50	22.6	25	93.1	100	
4PCE15E42P	PHK05BP	240	20.0	33.7	35	----	----	59.2	70
		208	15.0	30.2	35	----	----	55.8	60
	PHK07BP	240	7.5	46.7	50	----	----	72.3	80
		208	5.6	41.5	45	----	----	67.1	70
	PHK10BP	240	10	59.7	60	----	----	85.3	90
		208	7.5	52.8	60	----	----	78.3	80
	PHK15CP	240	15	59.7	60	26	30	111.3	125
		208	11.3	52.8	60	22.6	25	100.9	110
PHK20CP	240	20	59.7	60	52.1	60	137.4	150	
	208	15.0	52.8	60	45.1	50	123.5	125	

Heat Strip Electrical (48, 60)

Model No.	Heater Model	Unit Supply Single Phase	Heater kW	Minimum Circuit Ampacity 1	Maximum Fuse / HACR Brkr. 2 1	Minimum Circuit Ampacity 2	Maximum Fuse / HACR Brkr. 2 2	Minimum Circuit Ampacity Single	Max. Fuse/HACR Brke. Single
4PCE15E48P	PHK05BP	240	5.0	33.7	35	----	---	64	80
		208	3.8	30.2	35	----	---	60.6	70
	PHK07BP	240	7.5	46.7	50	----	---	77.1	90
		208	5.6	41.5	45	----	---	71.9	80
	PHK10BP	240	10.0	59.7	60	----	---	90.1	100
		208	7.5	52.8	60	----	---	83.1	90
	PHK15CP	240	15.0	59.7	60	26	30	116.1	125
		208	11.3	52.8	60	22.6	25	105.7	110
	PHK20CP	240	20.0	59.7	60	52.1	60	142.2	150
		208	15.0	52.8	60	45.1	50	128.3	150
4PCE13A60P	PHK05BP	240	5.0	33.7	35	----	---	66.8	90
		208	3.8	30.2	35	----	---	66.3	80
	PHK07BP	240	7.5	46.7	50	----	---	82.8	100
		208	5.6	41.5	45	----	---	77.6	90
	PHK10BP	240	10.0	59.7	60	----	---	95.8	110
		208	7.5	52.8	60	----	---	88.9	100
	PHK15CP	240	15.0	59.7	60	26	30	121.9	125
		208	11.3	52.8	60	22.6	25	111.5	125
	PHK20CP	240	20.0	59.7	60	52.1	60	147.9	150
		208	15.0	52.8	60	45.1	50	134	150

Accessories

Catalog Number	Description	Used with
92M51	Lift Bracket	All
92M54	Internal Filter Kit	4PCE15E 24,30,36
92M55	Internal Filter Kit	4PCE15E 42,48,60
92M99	Roof Curb 8 inch height	4PCE15E 24,30,36
93M00	Roof Curb 14 inch height	4PCE15E 24,30,36
93M01	Roof Curb 8 inch height	4PCE15E 42,48,60
93M02	Roof Curb 14 inch height	4PCE15E 42,48,60
10W47	5 kW Electric Heater Kit	All
10W48	7.5 kW Electric Heater Kit	All
10W49	10 kW Electric Heater Kit	All
10W50	15 kW Electric Heater Kit	4PCE15E 36-60
10W51	20 kW Electric Heater Kit	4PCE15E 42-60
13W88	Single Point Power for PHK05	5 kW Electric Heater Kit
13W89	Single Point Power for PHK07	7 kW Electric Heater Kit
13W90	Single Point Power for PHK10	10 kW Electric Heater Kit
13W91	Single Point Power for PHK15,20	15 and 20 kW Electric Heater Kit

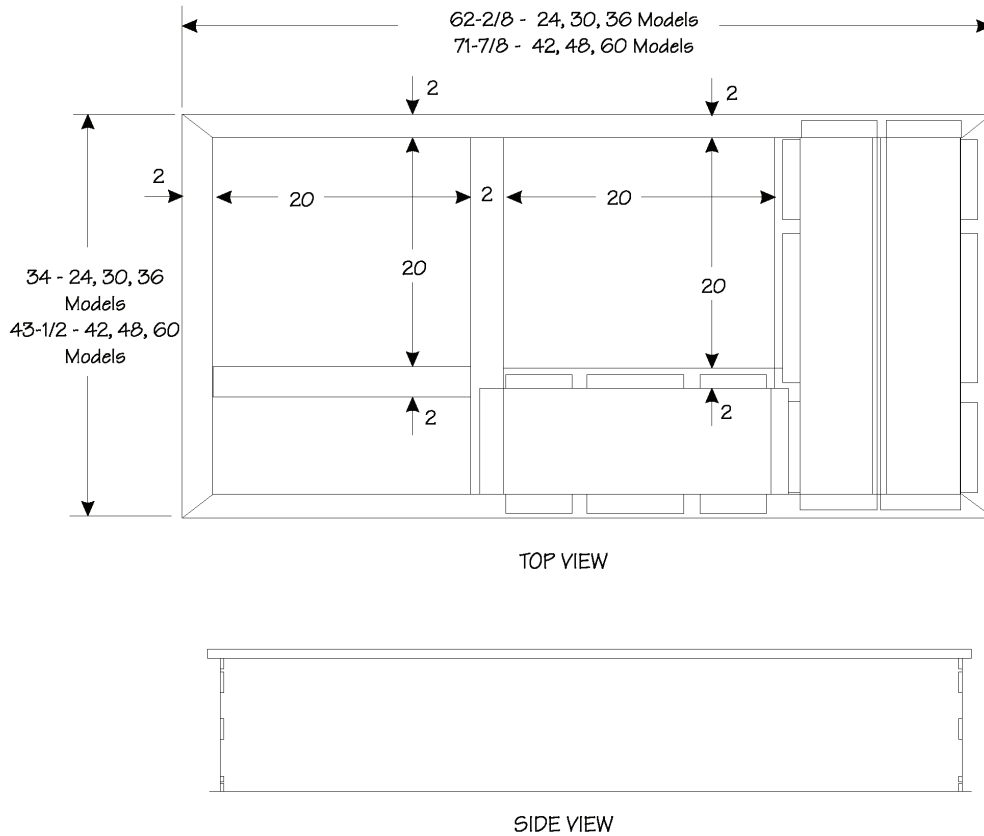

Dimensions (in.)

Model	A	B	C	D	E	F	G	H	J	K	L
4PCE15E24	34 1/4	65 3/8	36 1/2	11 1/4	17 1/4	20	8 1/2	3	20 1/4	4 1/2	19
4PCE15E30											
4PCE15E36											
4PCE15E42	38 1/4	75	46	11 1/4	19 1/4	22	9 1/4	3 1/4	22 1/4	4	16 1/4
4PCE15E48											
4PCE15E60											

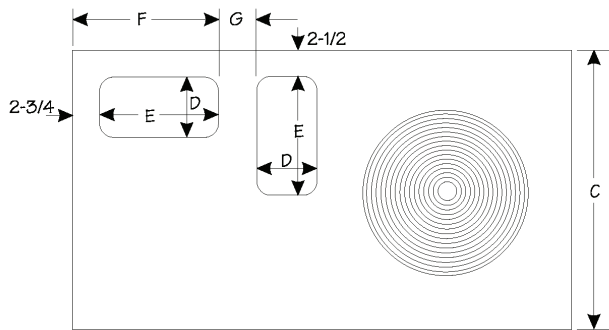

TOP VIEW

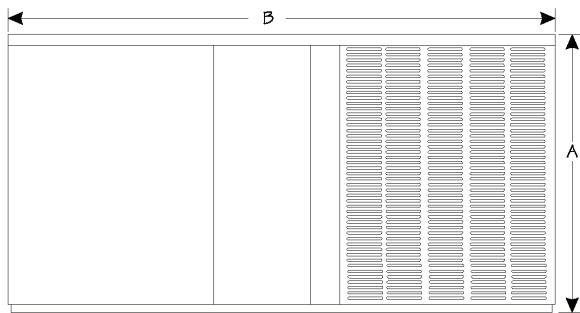

FRONT VIEW

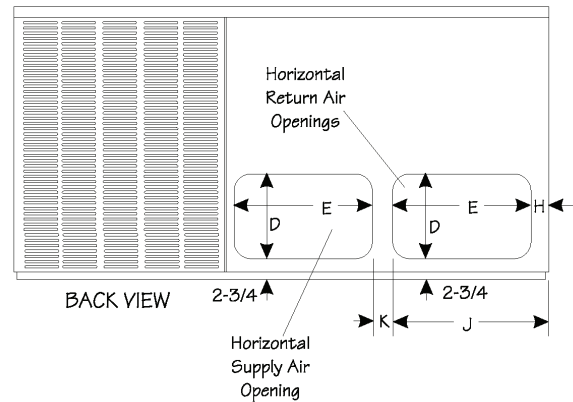

BACK VIEW

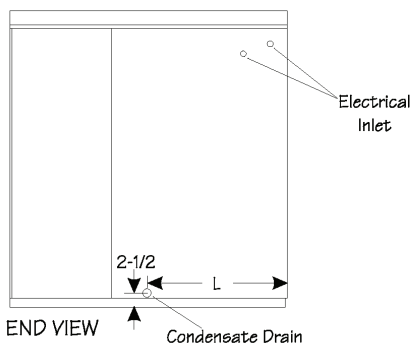

END VIEW

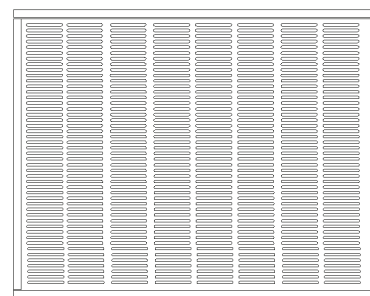

END VIEW

All specifications and illustrations
subject to change without notice
and without incurring obligations.

