

# 4PGE15E

15 SEER Gas / Electric  
Packaged Unit

## Product Specifications

Form No. 4PGE15E-100 (05/2013)

### REFRIGERANT SYSTEM

- Environmentally friendly R410A refrigerant
- Heavy-duty, high efficiency scroll compressor
- Copper tubing with enhanced fin coils

### HEAT EXCHANGER

- Aluminized steel tubular

### CABINET

- Insulation to minimize heat loss
- Baked on pre-painted steel cabinet finish
- Easy service access
- Louvered grille to protect condenser coil
- One piece "no leak" top design
- Aluminum fan for long life
- Internal filter rack

### BLOWER

- Insulated compartment to reduce sound
- Easy service split-ring design with quick plug-in wiring
- Variable speed motor for low maintenance and maximum efficiency

### CONTROLS

- Trade available components
- Solid state integrated blower control/ignition control board with L.E.D. diagnostics
- Color coded wiring for easy service

### ACCESSORIES

- Hinged Roofcurb
- Lifting Brackets
- Internal Filter Kits
- Low Ambient Kit
- LP Gas Conversion

### INSTALLATION

- Horizontal or down discharge
- All models comply with California Low NOx regulations
- Rectangular duct covers



### Warranty

- 10 year limited parts and compressor warranty/lifetime heat exchanger warranty available. See limited warranty document for details.

### Model Number Guide

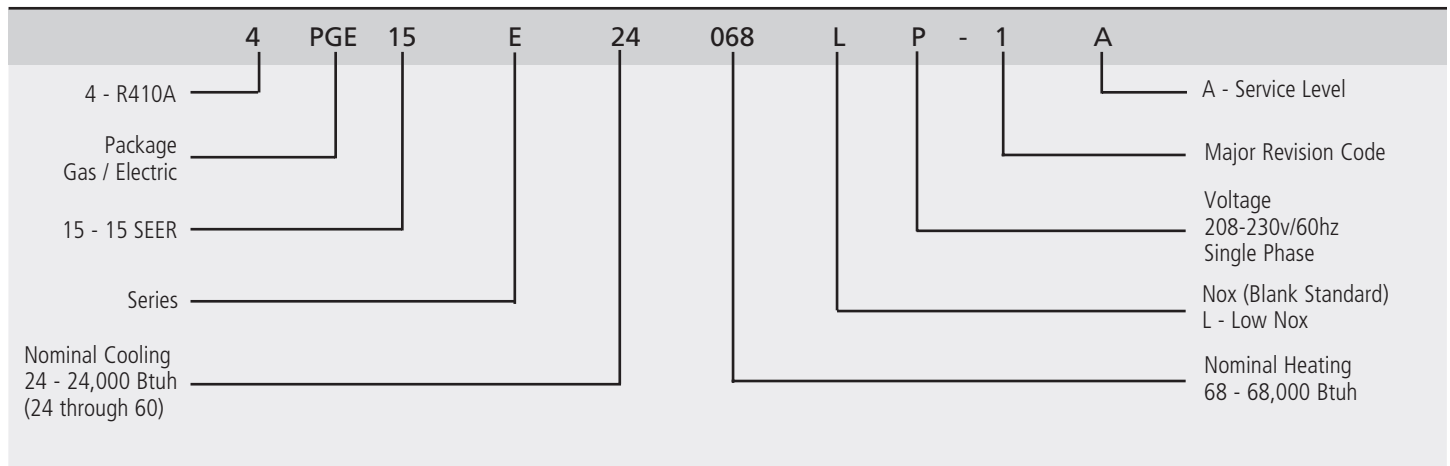

### Electrical and Physical Data

Model	Voltage/HZ/ Phase	Voltage Range	Min. Circuit Amp.	Max. Over Current Device (amps)	Compressor		Condenser Fan Motor			Indoor Blower Motor		Exhaust Motor		Refrig. Charge (oz.)	Weight (lbs.)
					Rated Load (amps)	Locked Rotor (amps)	Rated Load (amps)	Rated HP	Nom. RPM	Rated Load (amps)	Rated HP	Rated Load (amps)	Rated HP		
4PGE15E24	208-230/60/1	197-253	23	30	10.7	53	1.1	1/5	1075	2.9	1/3	1/30	1/3	74	390
4PGE15E30	208-230/60/1	197-253	24	35	11.6	59	1.1	1/5	1075	2.9	1/3	1/30	1/3	76	390
4PGE15E36	208-230/60/1	197-253	24	35	15.2	70	1.1	1/5	1075	3.7	1/3	1/30	1/2	78	405
4PGE15E42	208-230/60/1	197-253	32	45	21.1	90	1.7	1/4	825	6.1	1/3	1/30	3/4	98	520
4PGE15E48	208-230/60/1	197-253	40	60	24.1	100	1.7	1/4	825	6.1	1/3	1/30	3/4	102	540
4PGE15E60	208-230/60/1	197-253	41	60	25	134	1.7	1/4	825	6.1	1/3	1/30	3/4	148	592

**Performance**

Model	Cooling					Heating			
	SEER	EER	Rated AHRI Capacity <sup>1</sup> BRUH	Rated Sensible Capacity BTUH	CFM	Input BTUH	Output BTUH	Efficiency AFUE	Temp Rise Range °F
4PGE15E24068LP	14.50	12.0	22,800	17,700	800	67,500	54,000	80%	35-65
4PGE15E30068LP	14.00	12.0	28,000	21,200	1000	67,500	54,000	80%	35-65
4PGE15E36068LP	15.00	12.0	34,200	26,600	1200	67,500	54,000	80%	35-65
4PGE15E36090LP	15.00	12.0	34,200	26,600	1200	90,000	72,000	80%	35-65
4PGE15E42083LP	14.50	12.0	41,000	29,900	1400	82,500	66,000	80%	30-60
4PGE15E42110LP	14.50	12.0	41,000	29,900	1400	110,000	88,000	80%	45-75
4PGE15E48083LP	14.00	11.5	47,000	35,200	1600	82,500	66,000	80%	30-60
4PGE15E48110LP	14.00	11.5	47,000	35,200	1600	110,000	88,000	80%	45-75
4PGE15E48138LP	14.00	11.5	47,000	35,200	1600	137,500	110,000	80%	45-75
4PGE15E60083LP	14.00	11.5	57,000	41,500	1800	82,500	66,000	80%	30-60
4PGE15E60110LP	14.00	11.5	57,000	41,500	1800	110,000	88,000	80%	45-75
4PGE15E60138LP	14.00	11.5	57,000	41,500	1800	137,500	110,000	80%	45-75

**Blower Performance**

Model	Adjust Jumper Setting	Jumper Speed Positions											
		Cool Speed				Heat Speed				Continuous Fan Speed			
		A (cfm)	B (cfm)	C (cfm)	D (cfm)	A (cfm)	B (cfm)	C (cfm)	D (cfm)	A (cfm)	B (cfm)	C (cfm)	D (cfm)
4PGE15E24	+	1,150	920	690	1,035	1,265	1,150	1,035	920	575	460	345	520
	Norm.	1,000	800	600	900	1,100	1,000	900	800	500	400	300	450
	-	850	680	510	765	935	850	765	680	425	340	300	385
4PGE15E30	+	1,150	920	690	1,035	1,265	1,150	1,035	920	575	460	345	520
	Norm.	1,000	800	600	900	1,100	1,000	900	800	500	400	300	450
	-	850	680	510	765	935	850	765	680	425	340	300	385
4PGE15E36	+	1,380	1,150	920	1,265	1,555	1,265	1,150	1,035	690	575	460	635
	Norm.	1,200	1,000	800	100	1,350	1,100	1,000	900	600	500	400	550
	-	1,020	850	680	935	1,150	935	850	765	510	425	350	470
4PGE15E42	+	2,070	1,840	1,610	1,380	2,015	1,900	1,555	1,325	1,035	920	805	690
	Norm.	1,800	1,600	1,400	1,200	1,750	1,650	1,350	1,150	900	800	700	600
	-	1,530	1,360	1,190	1,020	1,490	1,405	1,150	980	765	680	595	510
4PGE15E48	+	2,070	1,840	1,610	1,380	2,015	1,900	1,555	1,325	1,035	920	805	690
	Norm.	1,800	1,600	1,400	1,200	1,750	1,650	1,350	1,150	900	800	700	600
	-	1,530	1,360	1,190	1,020	1,490	1,405	1,150	980	765	680	595	510
4PGE15E60	+	2,070	1,840	1,610	1,380	2,015	1,900	1,555	1,325	1,035	920	805	690
	Norm.	1,800	1,600	1,400	1,200	1,790	1,650	1,350	1,150	900	800	700	600
	-	1,530	1,360	1,190	1,020	1,490	1,405	1,150	980	765	680	595	510

### Cooling Performance Extended Ratings

Model	Indoor Temp DB/WB °F	Outdoor Temp - DB°F														
		65°			82°			95°			105°			115°		
		Btuh	S/T	kW	Btuh	S/T	kW	Btuh	S/T	kW	Btuh	S/T	kW	Btuh	S/T	kW
4PGE15E24	85/72	27,100	0.66	1.65	25,100	0.68	1.74	24,400	0.75	1.93	23,000	0.78	2.14	21,500	0.8	2.15
	80/67	25,300	0.73	1.49	24,200	0.73	1.7	23,000	0.78	1.92	21,700	0.81	2.13	20,300	0.83	2.13
	75/63	24,200	0.73	1.47	23,000	0.73	1.67	21,900	0.81	1.91	20,600	0.84	2.11	19,300	0.87	2.11
	75/57	22,000	1.00	1.46	21,100	1.00	1.7	20,500	1.00	1.88	19,300	1.00	2.1	18,100	1.00	2.09
4PGE15E30	85/72	33,300	0.64	2.02	30,800	0.66	2.14	29,900	0.73	2.37	28,200	0.76	2.63	26,400	0.78	2.64
	80/67	31,000	0.71	1.83	29,700	0.71	2.09	28,200	0.76	2.35	26,600	0.79	2.61	24,900	0.81	2.62
	75/63	29,600	0.71	1.8	28,200	0.711	2.05	26,800	0.79	2.33	25,300	0.82	2.59	23,600	0.84	2.59
	75/57	27,000	1.00	1.79	25,900	1.00	2.09	25,100	1.00	2.3	23,600	1.00	2.58	22,200	1.00	2.57
4PGE15E36	85/72	44,300	0.66	2.52	38,200	0.68	2.66	37,100	0.75	2.93	35000	0.77	3.26	32700	0.8	3.27
	80/67	38,500	0.73	2.28	36,800	0.73	2.59	35000	0.78	2.92	33000	0.8	3.25	30900	0.83	3.25
	75/63	36,800	0.73	2.25	35,000	0.73	2.54	33300	0.81	2.9	31400	0.83	3.22	29300	0.86	3.22
	75/57	33,500	1.00	2.23	32,200	1.00	2.59	31200	1.00	2.86	29300	1.00	3.21	27500	1.00	3.19
4PGE15E42	85/72	49,000	0.62	2.99	45,300	0.64	3.15	44,000	0.77	3.48	41,500	0.72	3.87	38,800	0.75	3.87
	80/67	45,700	0.68	2.7	43,700	0.68	3.07	41,500	0.73	3.46	39,200	0.75	3.85	36,600	0.78	3.85
	75/63	43,600	0.69	2.67	41,500	0.69	3.01	39,400	0.76	3.43	37,200	0.78	3.81	34,800	0.81	3.82
	75/57	39,800	1.00	2.65	38,200	1.00	3.07	36,900	1.00	3.39	34,800	1.00	3.79	32,600	1.00	3.77
4PGE15E48	85/72	62,900	0.61	2.92	57,200	0.64	3.52	52,800	0.66	3.99	49,200	0.68	4.46	45,700	0.69	4.54
	80/67	57,600	0.68	2.89	51,700	0.71	3.44	47,500	0.73	3.96	46,700	0.73	4.30	42,100	0.76	4.53
	75/63	54,800	0.70	2.87	49,400	0.73	3.46	45,100	0.75	3.91	42,000	0.77	4.38	38,900	0.79	4.46
	75/57	50,100	1.00	2.83	45,700	1.00	3.42	42,300	1.00	3.88	39,800	1.00	4.35	37,500	1.00	4.44
4PGE15E60	85/72	71,600	0.62	3.60	66,600	0.64	4.27	62,800	0.65	4.79	58,100	0.67	5.33	53,400	0.69	5.36
	80/67	66,500	0.68	3.56	62,100	0.70	4.18	57,000	0.72	4.75	53,700	0.75	5.20	48,900	0.77	5.31
	75/63	62,800	0.71	3.52	57,200	0.74	4.19	53,000	0.76	4.70	48,900	0.78	5.22	44,900	0.80	5.26
	75/57	57,900	1.00	3.49	53,800	1.00	4.15	50,700	1.00	4.66	47,100	1.00	5.17	43,500	1.00	5.20

Accessories

Description	Where Used	Kit Number
34M72	Low Ambient Kit	All 4PGE's
92M51	Lifting Brackets	All 4PGE's
92M54	Internal Filter Kit	4PGE24, 30, 36
92M55	Internal Filter Kit	4PGE42, 48, 60
92M57	LP Conversion Kit	4PGE68 and 90
92M58	LP Conversion Kit	4PGE83, 110 and 138
92M99	Roof Curb 8 inch height	4PGE24, 30, 36
93M00	Roof Curb 14 inch height	4PGE24, 30, 36
93M01	Roof Curb 8 inch height	4PGE42, 48, 60
93M02	Roof Curb 14 inch height	4PGE42, 48, 60

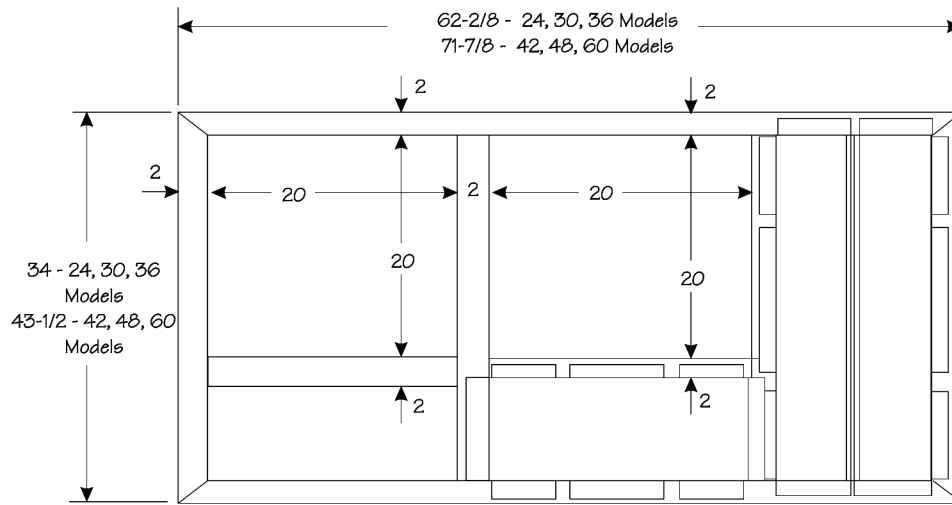

TOP VIEW



SIDE VIEW

Dimensions (in.)

Model	A	B	C	D	E	F	G	H	J	K	L
4PGE15E24	34-1/4	65-3/8	36-1/2	11-1-4	17-1/4	20	8-1/2	3	20-1/4	4-1/2	19
4PGE15E30											
4PGE15E36											
4PGE15E42	38-1/4	78	46	11-1-4	19-1/4	22	9-1/4	3-1/4	22-1/4	4	16-1/4
4PGE15E48											
4PGE15E60											

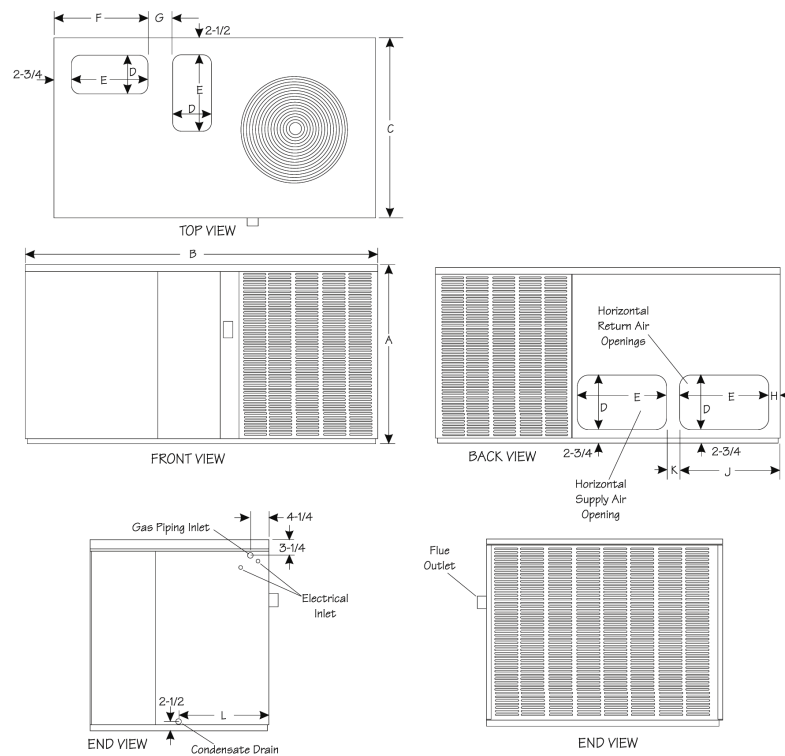

Revisions		
Section	Page #	Description
Electrical and Physical Data	2	Ratings table revised
Performance	3	Rating tables revised

All specifications and illustrations subject to change without notice and without incurring obligations.

